

MILA L DESK

Technical Data Sheet





MILA L DESK

Designer: Adnan Serbest

Mila stands out as a product group that conveys minimalism with understated details, living simplicity, and sharing these principles with its users. Mila L Desks provide a refreshing look to minimal spaces in your office while solving basic needs with the drawer unit.

DESCRIPTION

METAL STRUCTURE

The metal legs are made from 25x25x1.5 mm metal profiles. A welded tabletop connection part made from 5 mm thick DKP steel is attached to the top of the metal legs, produced using CNC laser cutting. All metal parts are coated with a 90-micron thick textured (pebbled) electrostatic powder paint. They can be painted in any static color from the Zivella Metal Color Chart.

WOODEN STRUCTURE

The desk top, modesty panel, and separator are made from 25 mm thick melamine-coated particle board. The desk top, modesty panel, and separator can be produced in all colors and patterns from the Zivella Particle Board Color Chart.

PEDESTAL BODY

The pedestal body is made from 18 mm thick, melamine-coated particle board. The connection to the desk top is made using 25 mm thick melamine-coated particle board.

ACCESSORIES

The desk top, modesty panel, and separator are connected to each other using Minifix, plastic dowels, and screws. The desk top and legs are connected using wood screws attached to the metal sheets on the legs. Height-adjustable plastic bingo feet are used on the bottom of the metal legs where they make contact with the floor. All pedestal panels are connected using Minifix and plastic dowels. The pedestal uses 5 cm high, height-adjustable plastic feet where it contacts the floor. The drawer handles are made using an aluminum extrusion production method. The handles are coated with 90-micron thick textured (pebbled) electrostatic powder paint. The drawers use 40 cm telescopic slides for single opening. The drawers of the pedestal can be locked using a central locking system.

USAGE AREA

Mila L Desks are designed for workspaces such as offices.

DESIGNER / COLLECTION

Mila L Desks were designed by Adnan Serbest for the 2022/2023 collection.

MATERIAL LIBRARY

Zivella; you can access the wood, metal, fabric, and faux leather library using the QR code below.



Material Catalog



DIMENSIONS

MILA L DESK

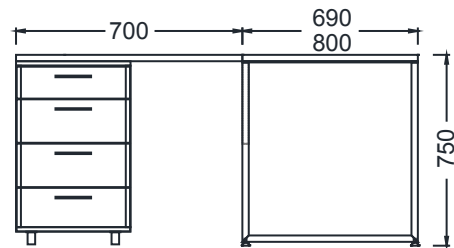
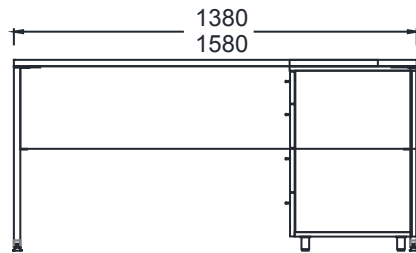
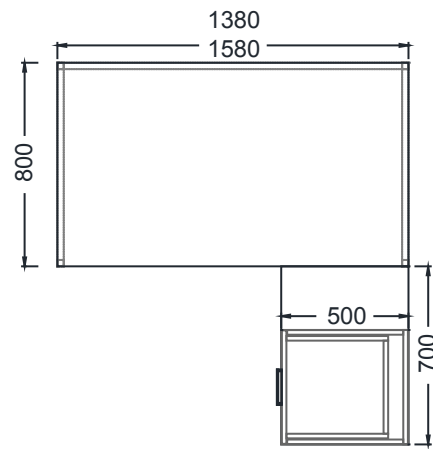
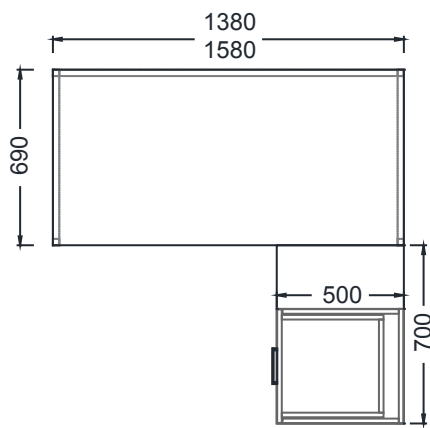

MLM70140 - MILA L DESK 70X140
MLM70160 - MILA L DESK 70X160

MLM80140 - MILA L DESK 80X140
MLM80160 - MILA L DESK 80X160

Measurements are in millimeters.